

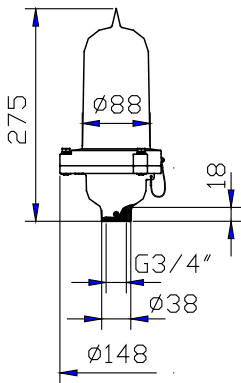

Patent No. 200920068564.3



Installation dimension (mm)



Connect diagram

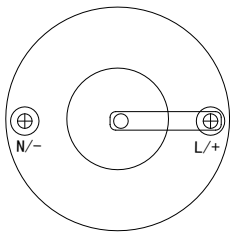

Application



Application

ABC-7L Single Aviation Obstruction Light for marking towers(Telecom, GSM), Cranes, Hoists,Smokestacks, Buildings, Wind generator and any other potentially hazardous obstructions to air traffic.

Main Functions & Features

- Base is made of die casting aluminum alloy, with light weight and corrosion resistance.
- ABC-7A(LED) bulb uses super brightness LED, and its life time more than 100,000hrs.
- PC cover is used for ABC-7A(LED) bulb, providing good intensity, thermal stability and good finishing surface.
- The lamp housing and upper lamp holder are sealed with structural glue, to ensure the good watertight of the product.
- A bird spike is provided on the top to avoid the drop of the bird.
- Built-in photocell, can switch ON/OFF the light at dawn and night automatically.(optional)

Specifications

International standard	ICAO(Aerodromes Annex 14) Low intensity ; FAA-L810	Vertical degree	≥10°
Light source	LED	Horizontal degree	360°
Light color	Red, Amber, Green, Blue, White(Optional)	Work way	Steady burning or flash (optional)
Operating voltage	AC110V~AC240V/DC12V/DC24V/DC40V~DC60V(other voltage can be customized)	Visible distance	> 3.5KM(AT=0.85)
Power consumption	5W	LED life	≥100,000hrs
Intensity	>10cd		
Ambient temperature	-30°C ~ +70°C	IP Protection	IP65
Humidity	10% ~ 95% (No coagulation)	Weight	1.25kg
Material	Base :Aluminum alloy Housing :PC		

Installation and operation

- Check whether the supply voltage does comply with the rated voltage of the lamp(Pay attention to the polarity in case of DC voltage)
- Insert the power cable through the bottom of lamp holder, and connect them to the terminals in the base respectively.
- Connect the earth wire to the corresponding earth terminals.
- Tighten the screws between lamp housing and base.
- Screw the lamp on the G3/4" (G1") threaded pipe, which should be fixed on a smooth surface with enough mechanical strength.
- Verify whether the power cables are well connected before power on.

Models

Model	Function & Characteristic	
	Characteristic	Remark
ABC-7L	Steady burning	
ABC-7LP	ABC-7L with photocell	Controlled illumination of light-operated switch : 70/100lux
ABC-7LQ	ABC-7L with photocell and flash type	Controlled illumination of light-operated switch : 70/100lux Flash frequency : 30~40times/min
ABC-7LS	Flash type	Flash frequency : 30~40times/min

Notice

- The part of material of products is PC(like lamp cover and lamp shell), so it cannot direct or indirect touch the organic solvent, such as industrial alcohol, banana oil, isopropyl alcohol, carbon tetrachloride, cyclohexanone and so on, otherwise, the product will be corroision.